



constructive solutions

LIQUID WATERPROOFING PRODUCT

NITOPROOF® 610

Flexible, versatile polyurethane liquid waterproofing membrane for internal and external areas.

Nitoproof 610 is a single-component thixotropic polyurethane liquid that cures by reaction with atmospheric moisture to give a tough flexible waterproof membrane. It has high elasticity, excellent bond strength and low water permeability.

ADVANTAGES

- High elongation
- Ready to apply direct from can - no mixing required
- Produces a permanently flexible resilient barrier over a range of service temperatures - minus 20°C to +80°C
- Excellent build properties for horizontal surfaces
- Can be applied to a wide range of substrates
- Outstanding barrier properties - protection against corrosive soil conditions
- Irreversible chemical cure eliminates melting and flow at high temperature
- Excellent resistance to embrittlement
- Pitch free formulation
- Meets the performance requirements of AS/NZS 4858:2004 Wet Area Membranes as a Class III membrane.



TYPICAL APPLICATIONS:

Suitable for both vertical and horizontal surfaces, including foundations, basements, tunnels, ground floors, suspended floors, roof terraces, balconies, patios and bridges.

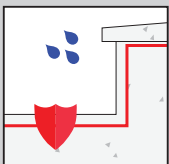

Waterproofing

For further information on our waterproofing range visit www.fosroc.com.au or fosroc.co.nz
Always refer to the product TDS before making your final selection or speak to your Fosroc representative.

Nitoproof 610

Design Criteria

Nitoproof 610 is designed to be applied by roller or trowel to achieve a wet film thickness of not less than 1.5 mm (approx. 1.3 mm dry film thickness).

Properties

Form:	Single-component moisture curing polyurethane viscous liquid
Colour:	Black
Solids content:	> 85%
VOC content:	190g / litre
Physical or chemical change:	Chemical cure by reaction with atmospheric moisture
Elongation at break:	> 500%
Tensile Bond Strength	1.0 N/mm ²
Tack free time at 20°C 50% RH:	3 hours
Full cure time at 20°C 50% RH:	24 hours at 1.5 mm WFT
Re-coating interval:	6 to 12 hours
Application temperature:	5°C - 35°C
Service temperature (continuous ambient):	Minus 20°C to +80°C

Chemical Resistance

Nitoproof 610 is unaffected by a range of mild acids, alkalis, water borne salts, and is resistant to bio-degradation. Highly resistant to detergents and bleach based cleaning products.

Coverage Guide

1.5 litres of Nitoproof 610 will provide 2 coats to a 1m² area, with a resultant WFT of 1.5mm.

Typical application rate at 1.5 mm WFT: 10 m² per 15L pack.

Supply

Product code	Description	Size
FC000627-15L	Nitoproof 610	15L

Fosroc Nitoproof Range

Nitoproof 610 complements the Fosroc range of polyurethane liquid waterproofing membranes.

	Nitoproof 610	Nitoproof 750	Nitoproof 810
Description	A single component moisture cure polyurethane liquid that produces a flexible waterproofing membrane.	A single component moisture cure polyurethane liquid that produces a tough flexible elastomeric waterproofing membrane.	Highly flexible Class III, single component, water based polyurethane liquid waterproofing membrane.
General Advantages	Versatile - can be applied to a wide range of substrates.	Resistant to aggressive soil conditions. Can be applied to a wide range of substrates.	Direct stick tiles to membrane, very low VOC.
Technology	Moisture cure polyurethane	Moisture cure polyurethane	Water based polyurethane
Typical Applications	Foundations, basements, tunnels, ground floors, suspended floors, roof terraces, balconies, patios and bridges.	Foundations, basements, roofs and tunnels.	Wet areas, enables the direct fix of ceramic tiles, screeds, and renders over the dried membrane using Nitotile Flex polymer modified cement based tile adhesive.

AU 1800 812 864
fosroc.com.au

NZ 0800 657 156
fosroc.co.nz

Parchem Construction Supplies Pty Ltd
1956 Dandenong Rd, Clayton VIC AUS 3168

Distributed in New Zealand by Concrete Plus Ltd
150 Hutt Park Road, Gracefield NZ 5010

Fosroc, the Fosroc logo and Nitoproof are trade marks of Fosroc International Limited, used under licence.