



constructive solutions

SHEET APPLIED WATERPROOFING

PROOFEX® PGP

PVC waterproofing membrane

Flexible PVC synthetic membrane that provides a continuously loose laid or fully bonded waterproofing system. The membrane is coloured light grey on top and black on the underside to help identify any damage that may occur during application.

ADVANTAGES

- ✓ Cold applied
- ✓ Good resistance to puncturing
- ✓ Fast installation
- ✓ Hot air welded joints for maximum watertightness – hand applied or using automatic machines
- ✓ High flexibility in cold temperatures



TYPICAL APPLICATIONS

Recommended for waterproofing basements, tunnels, podiums, covered roofs and green roofs.

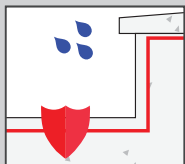

Waterproofing

For further information on waterproofing range visit fosroc.com.au or fosroc.co.nz

Always refer to the product TDS before making your final selection or speak to your Fosroc representative.

PROOFEX® PGP

Properties

Thickness (EN 1984-2):	2mm
Tensile strength (ASTM D412 and EN12311-2)	
Longitudinal:	6.5 N/mm ²
Transverse:	15 N/mm ²
Elongation at break (ASTM D412 and EN12311-2)	
Longitudinal:	>300%
Transverse:	>300%
Puncture resistance (EN12236):	2.6 KN
(ASTM E154):	1200 N
Water impermeability (EN 1928):	Pass test
Water vapour transmission (ASTM E96):	Nil
Tear resistance (EN12310-1):	>340 N
(ASTM D624):	50 N/mm ²
Lap joint strength (EN12317 and UEATc):	>1000 N/50mm (broken out joint)
Cold flexibility (EN495-5 @ -35oC):	Pass
Root resistance (EN TS14416):	Pass test – no penetration

Proofex PGP Accessories

Proofex PGP Fitter

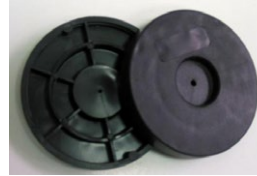

Proofex PGP Fitters are 80mm diameter PVC ribbed discs which are shaped with a central inset to take a washer for the fixing nail. Provides a weldable fixing detail for vertical installations of Fosroc Proofex PGP membrane.

Proofex PGP Flange



Proofex PGP Flanges are 180mm diameter PVC disc flanges with a connector pipe. Provides a conical hose connection for future injection with resin for PVC membrane compartment systems.

Proofex PGP Sleeve



Proofex PGP Sleeve is a prefabricated ready to install piece of hard PVC tube with a flange. The flange is welded to a shoulder of Proofex PGP membrane to provide a water-tight seal around anchor penetrations.

Supply

Product code	Description	Size	Minimum Order Quantity (MOQ)/must be ordered in quantities of
FC007100-UNIT	Proofex PGP	2.1m wide x 25m roll	1
FC007101-UNIT	Proofex PGP Fitter	Diameter: 80mm	100
FC007102-UNIT	Proofex PGP Flange	Diameter: 180mm	10
FC007103-UNIT	Proofex PGP Sleeve	Height: 200mm Sleeve diameter: 28mm Shoulder diameter: 120mm Welded piece diameter: 300mm	30

AU 1800 812 864
fosroc.com.au

NZ 0800 657 156
fosroc.co.nz

Parchem Construction Supplies Pty Ltd
1956 Dandenong Rd, Clayton VIC AUS 3168

Distributed in New Zealand by Concrete Plus Ltd
150 Hutt Park Road, Gracefield NZ 5010

Fosroc, Proofex and the Fosroc logo are trade marks of Fosroc International Limited, used under licence.