



constructive solutions

## FULLY-BONDED WATERPROOFING MEMBRANE

# PROOFEX<sup>®</sup> ENGAGE

### Innovative, anti-tracking, pre-applied waterproofing system.

For below-ground structures where the exterior face of the structural concrete is inaccessible, the waterproofing must be applied prior to pouring the concrete. Loose-laid or self-adhesive systems are applied to the substrate not the structural concrete, this means there is no seal between the waterproofing and the structural concrete, if there is a leak water can track between the waterproofing and the structure. A similar problem occurs where ground settlement takes place.

Fosroc Proofex Engage is a proprietary, innovative, pre-applied waterproofing system that incorporates a unique cell mesh which mechanically bonds to freshly placed concrete, giving a tenacious waterproof seal and preventing water migration even if ground settlement occurs.

### ADVANTAGES

- Unique mesh system bonds permanently to concrete, remaining in place even if settlement takes place
- No water-tracking
- Simple and quick to install - no protection film to remove
- Methane and CO<sub>2</sub> protection as defined in BRE Report 212
- Radon protection as defined in BRE Report 211
- Protects concrete from attack from chemicals, hydrocarbons and aggressive ground salts in contaminated sites
- Simple application - requires no primer or protection, blinding concrete may be eliminated
- Immediately trafficable
- Root resistant
- Basement waterproofing protection to grades 1, 2 and 3 as defined in BS8102:2022
- BRANZ appraised

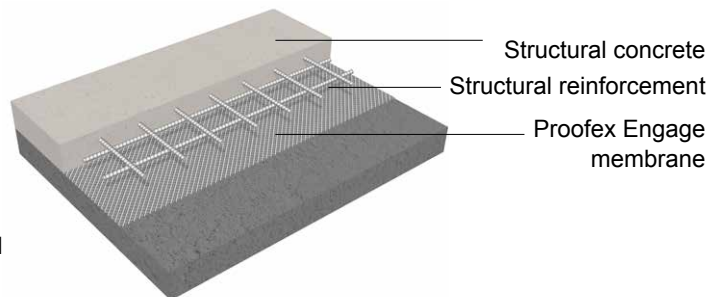

### TYPICAL APPLICATIONS:



Walls



Floors

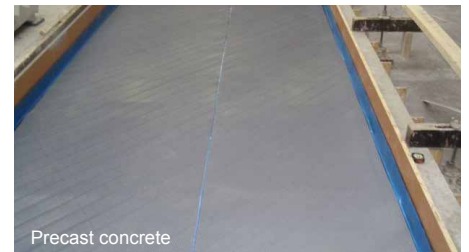

Precast concrete

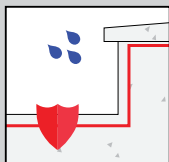

Waterproofing

For further information about our waterproofing range visit [www.fosroc.com.au](http://www.fosroc.com.au) or [fosroc.co.nz](http://fosroc.co.nz)  
Always refer to the product TDS before making your final selection or speak to your Fosroc representative.

# Fosroc Proofex® Engage

## Properties

Test Method	Standard	EN13967 Requirement	Result
Watertightness to liquid water	EN 1928 Method A	No evidence of water penetration @ 6m head	Pass Also ASTM D5385 passed at 69m
Resistance to static loading	EN 12730 method B	-	20kg
Tensile properties (membrane sheet only): Tensile strength/elongation at break/elongation at peak load:	EN 12311-2	-	Transverse: >10.0 MPa / >600% / >600% Longitudinal: >18.0 MPa / >800% / >800%
Tensile properties (composite sheet plus mesh): Tensile strength/ elongation at break/ elongation at peak load:	EN 12311-2 *Tensile strength based on sheet thickness	-	Transverse: >7.0 MPa / >120% / >15% Longitudinal: >9.0 MPa / >140% / >50%
Crack bridging:	ASTM C1305 modified	-	up to 5mm (100 cycles)
Durability of watertightness against ageing	EN 1296 / EN 1928	-	Pass
Resistance to impact Puncture resistance Resistance to roots	EN 12691 Method A ASTM E154-08 EN/TS 14416	-	1500 mm. 672N Pass
Resistance to tear (nail shank)	EN 12310-1	-	720 N (longitudinal)
Reaction to fire	EN ISO 11925-2	-	Pass
Lapped joint strength	EN 12317-2	-	≥ 400 N
Water vapour transmission	EN 1931	-	Water vapour resistance factor u = 580000 Equivalent air layer thickness S <sup>d</sup> = 400 metres
Resistance to alkali	EN 1847 / EN 1928	Watertight @ 2kPa @ 60kPa	Pass Pass
Length Width Thickness Mass Straightness Visible defects	EN 1848-2	-	33 metres 1.15 metres 4-5mm overall 1.54 kg/m <sup>2</sup> <75 mm per 10 metre length Free from visible defects
Methane permeability	BS ISO 15105-1:2007	-	127ml-m <sup>2</sup> -day <sup>-1</sup> -atm <sup>-1</sup> (unjoined)
CO <sub>2</sub> permeability	Rilem Report 12	-	<5.12 E-13 m <sup>2</sup> /sec/Pa
DC Resistance or Conductance of insulating materials - volume resistivity	ASTM D257-14(2021) e1	-	1325526 x 10 <sup>11</sup> ohm-cm

Clarification of property values: The typical properties given above are derived from laboratory testing. Results derived from field applied samples may vary.

## Supply Including Proofex Engage ancillary products

Product code	Description	Size
FC007074-UNIT	Fosroc Proofex Engage	1.15m x 33.1m long roll
FC007077-UNIT	Fosroc Proofex "L" section	125mm x 125mm x 10m long roll
FC007072-UNIT	Fosroc Proofex Engage 'External' corner	125mm x 125mm x 125mm
FC007073-UNIT	Fosroc Proofex Engage 'Internal' corner	125mm x 125mm x 125mm
FC007071-UNIT	Fosroc Proofex Detail Strip	200mm x 1.5mm x 10m long roll
FC007078-UNIT	Fosroc Proofex Top Hat – diameter 110mm	330mm x 330mm
FC007079-UNIT	Fosroc Proofex Top Hat – diameter 160mm	380mm x 380mm
FC007082-600ML	Fosroc Polyurea SCS Gun Grade	2 x 300ml cartridge (600ml)
FC007094-UNIT	Fosroc Polyurea SCS - Static Mixing Nozzles	N/A
FC007087-UNIT	Fosroc Polyurea WCS - Manual Gun	N/A

## Standard Compliance

BRANZ Appraised:  
Appraisal No. 1035 (2018)

Independently certified performance,  
BBA Certificate No. 03/4042.



BS EN 13967:2004 - Flexible sheets for waterproofing - Plastic and rubber damp proof sheets including plastic and rubber basement tanking sheet. Type A and Type T.

British Standard 8102:2022 - Code of Practice for 'Protection of Structures against Water from the Ground' classes 1, 2 and 3.

Green Label Singapore labelling scheme - approved as "environmentally preferred coating".



Fosroc Ltd, Drayton Manor Business Park, Coleshill Road,  
Tamworth, Staffs, B78 3TL DOP: UK9-56 0809 CPR 20006780

EN 13967:2012 – Flexible sheets for waterproofing - Plastic and rubber damp proof sheets including plastic and rubber basement tanking systems

Class	Type A and Type T
Watertightness	Pass
Resistance to impact	>1.5m
Dangerous substances	Conforms with 5.17
Resistance to static load	20kg
Elongation at break	L >140%, T >120%
Tensile properties	L >9N/mm <sup>2</sup> , T >7N/mm <sup>2</sup>
Water vapour resistance after ageing	Pass
Resistance to tearing	720N (longitudinal)
Shear resistance of joints	>400N lap
Water vapour properties	S <sup>d</sup> = 400m

AU 1800 812 864

fosroc.com.au

NZ 0800 657 156

fosroc.co.nz

Parchem Construction Supplies Pty Ltd  
1956 Dandenong Rd, Clayton VIC AUS 3168

Distributed in New Zealand by Concrete Plus Ltd  
150 Hutt Park Road, Gracefield NZ 5010

Fosroc, the Fosroc logo and Proofex are trade marks of  
Fosroc International Limited, used under licence.

01/24